

Easyrig Vario 5 mounting instructions

The Vario 5 installation is done in two steps. The mounts on the Vario 5 will stay on the Easyrig all the time, while the other mounts are quickly removed when needed.

Please take off the plastic cover and remove the Vario 5 from the Easyrig vest. Keep the nuts and screws.

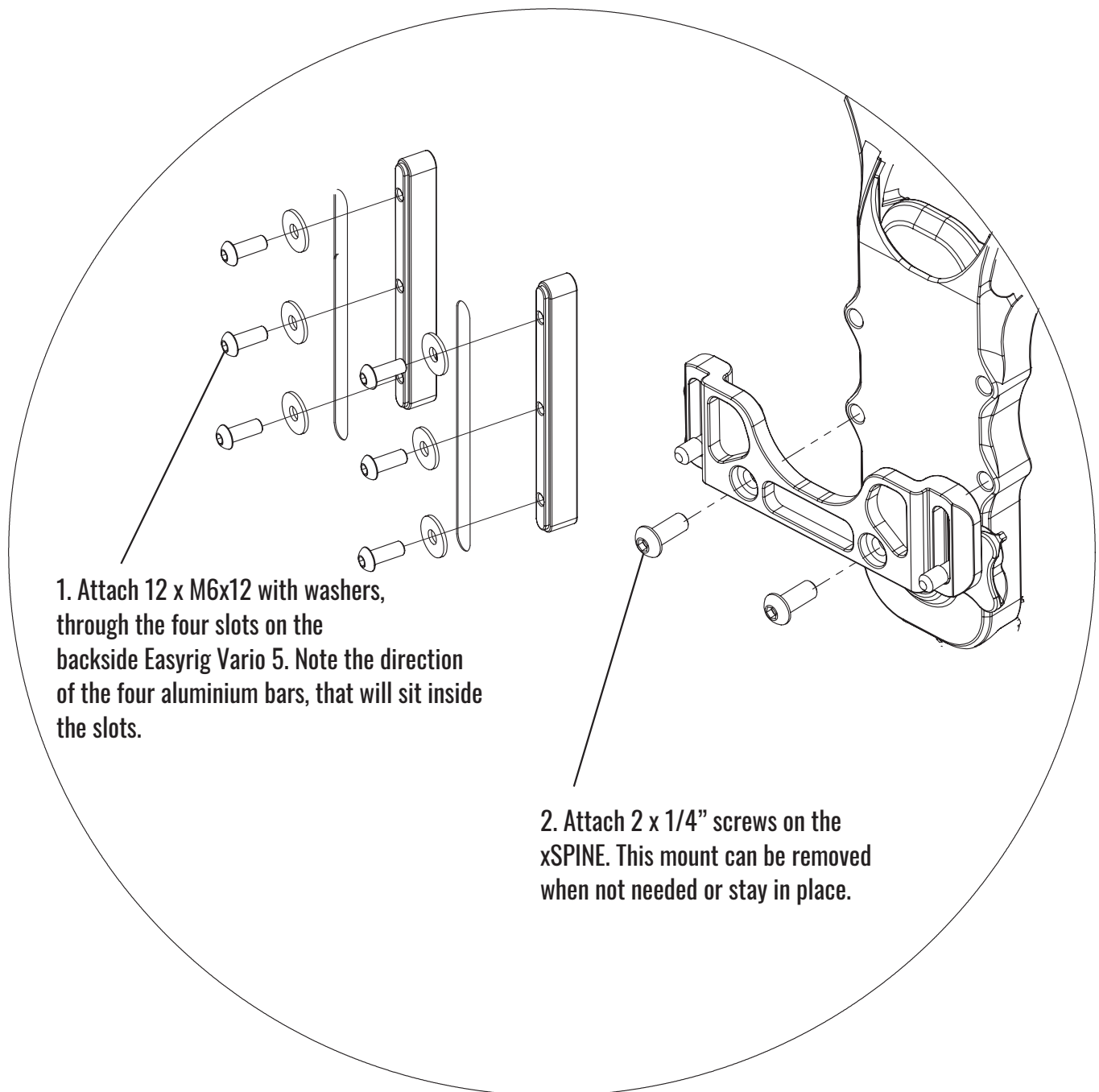

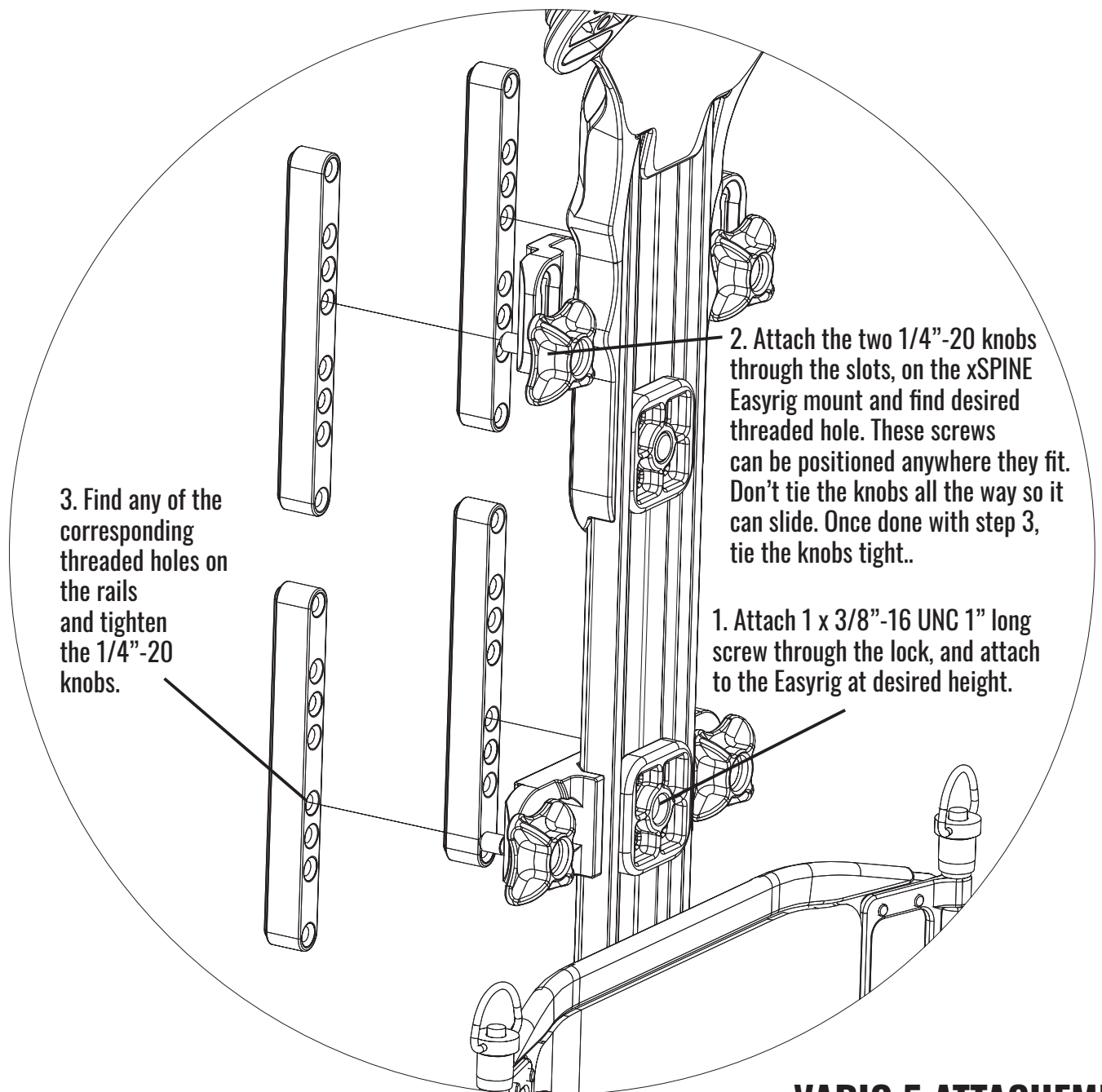

VARIO 5 ATTACHEMENT

Example pictures of installation:

